



Omega National  
P R O D U C T S

## P0441MNL Base Pantry Installation

### Installation Instructions

**Step 1:** Center the mounting bracket panel in the back of the cabinet and fasten to the back of the cabinet. Put the center guide rail in the notch and center and fasten it to the bottom of the cabinet (this may need to be trimmed). Fasten the angle bracket stop beside the center rail.

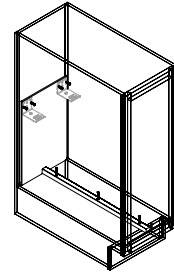

**Step 2:** Remove the Blum Undermount slides from the Pantry and insert them in the back mounting brackets and using a square square the slide off the face frame keeping it back 1/8" from the front of the face frame. Mark and pre-drill the holes and mount the slide.

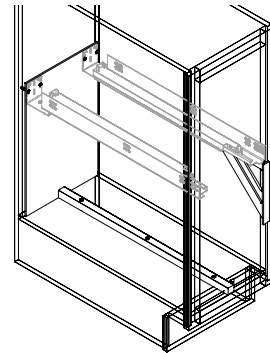

**Step 3:** Tip the pantry into the cabinet over the angle bracket and onto the center rail. Slide the pantry onto the slides and click into position.

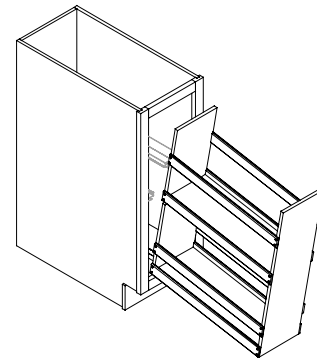

**Step 4:** Make the necessary adjustments so it moves freely and is centered and level.

